

## Pack contents:

- 1 x Outer furniture (assembled)
- 1 x Inner furniture (assembled)
- 2 x Handing blocks
- 2 x Handing block fixing screws
- 2 x Short furniture fixing screws
- 2 x Long furniture fixing screws
- 1 x Short spindle
- 1 x Long spindle

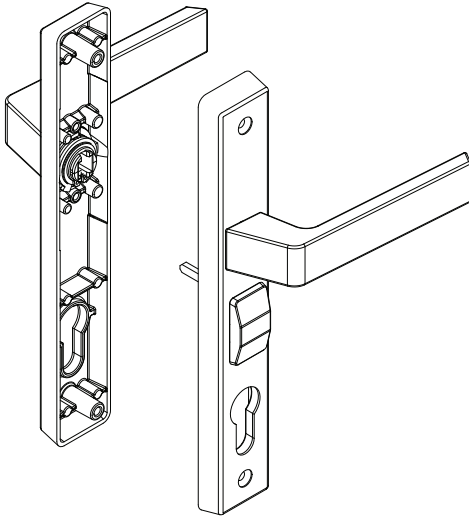

## 1. Door preparation

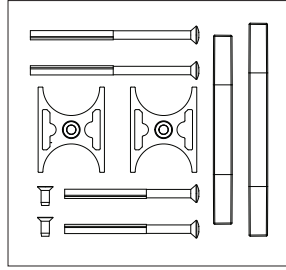
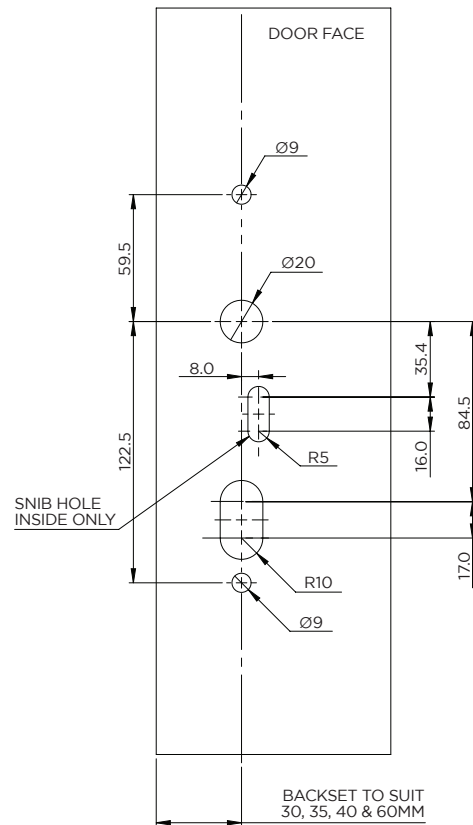

## 2. Lever handing - External and Internal

- On the external furniture, rotate the lever as required
- Insert the lever handing block
- Fix the handing block using the handing block fixing screw
- Repeat these steps for handing lever on internal furniture

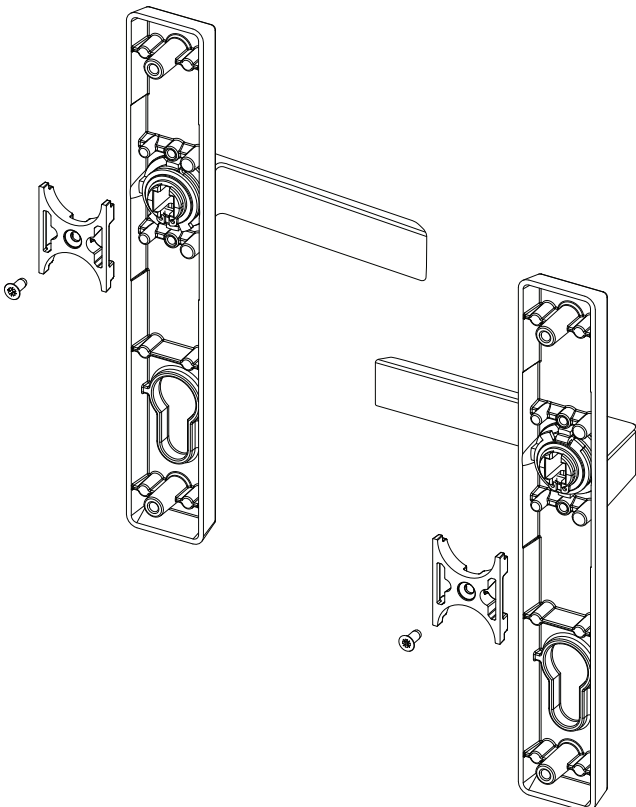

## 3. Snib tail piece positioning

- After handing the internal furniture, snib tail piece should be positioned correctly so that it engages into the mortice lock
- To change the tail piece orientation, loosen the screw used to fix the tail piece to the snib
- Rotate the tail piece on to the correct position and tighten the screw ensuring no play

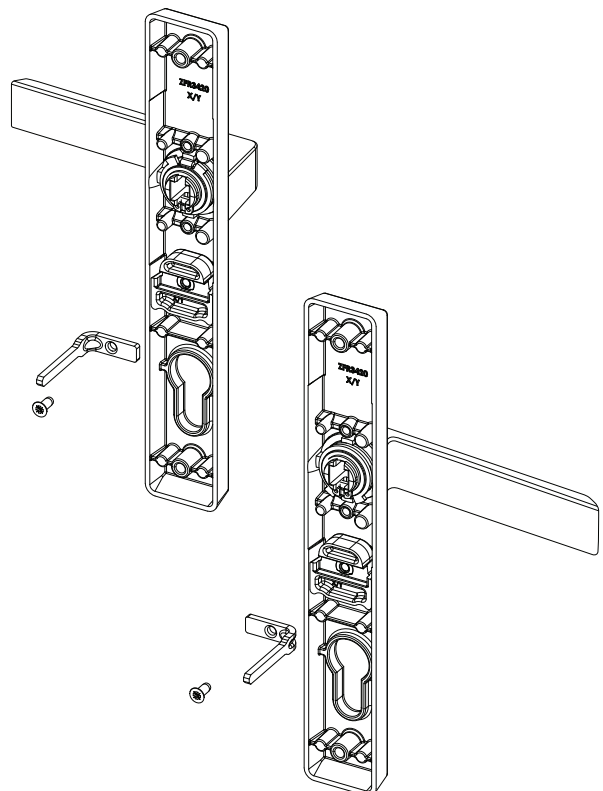

#### 4. Assemble to door

- Insert appropriate spindle into the external furniture lever and assemble to the door ensuring the spindle fits through the mortice lock
- Assemble the internal furniture onto the door, ensuring the spindle engages the lever, and the snib tail piece engages the mortice lock.
- Secure furniture as shown below using appropriate length screws.

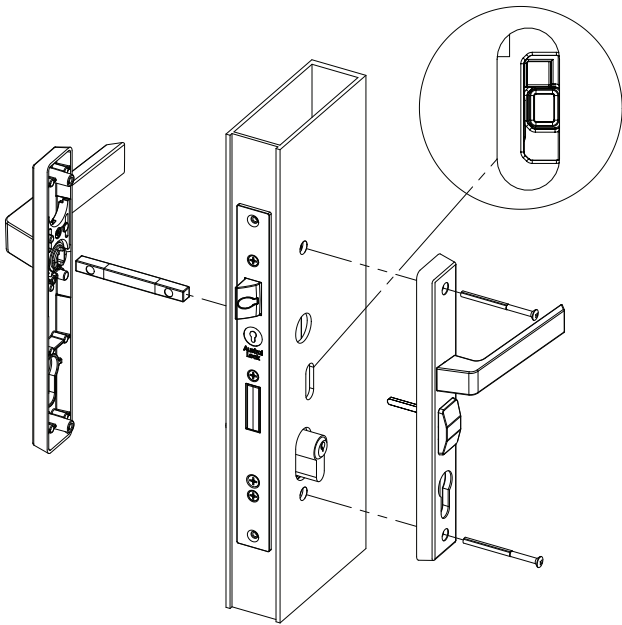

#### 5. Product overview

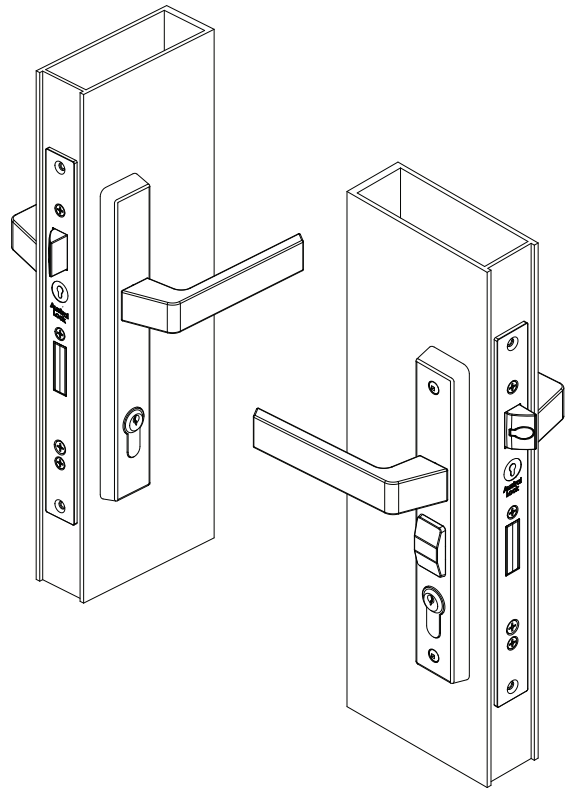

### CARE & MAINTENANCE

#### Installation

The product must be installed according to the instructions included in the product packaging and the door should be apertured according to the door “cut-out” dimensions and tolerances shown.

Prior to fitting ensure that:

Doors stored on site are stored in a clean dry area free from cement, lime, paint, acid etc.

During fitting of the lock ensure that:

- No metal swarf or other contaminants enter the lock body.
- The fixing screws do not damage the product finish.
- *Ensure that screws are not overtightened. Especially when using power tools*

After installation of the door ensure that:

- The door is correctly adjusted with the correct clearances.
- The lock engages the strike plate correctly.
- The door is protected from building fall-out such as wet plaster, mortar, paint and welding splatter.

If the door becomes contaminated:

- Do not paint the lock body or faceplate.
- Remove wet plaster, cement, mortar and other droppings immediately, using ample clean water and a sponge or rag, to avoid permanent staining or scratching of the product finish.
- If removal is delayed and scraping becomes necessary the surface finish may suffer.

#### Maintenance

- Annually inspect the door to confirm that the door operates with the correct clearances, closes and opens without obstruction and confirm that the lock beak slides easily into the strike plate aperture when the door is closed - adjust the door if necessary.
- Annually check that when the door is closed, the lock can be locked by key and by the snib lever.
- Quarterly wipe the strike plates with a soapy rag to remove built up debris and to lubricate the strike plate.

**NOTE :** The lock assembly has been lubricated for life, and should not be disassembled by the user.

#### Cleaning Powder Coatings

Every six months, powder coated surfaces should be cleaned to protect the finish. However, in areas where pollutants are more prevalent, especially in coastal or industrial regions, cleaning should be carried out every two to three months. To clean the powder coated surface:

- Carefully remove any loose deposits with a wet sponge.
- Use a soft brush (non abrasive) or cloth and a mild household detergent solution to remove dust, salt and other deposits. Do not use steel wool, scrapers, scouring liquids or powders to remove deposits as these permanently scratch the coating surface.
- Rinse off with clean fresh water

PDAU003B



**ALLEGION™**

1800 098 094  
info.au@allegion.com  
ausloc.com